

CABINET LOCK

USER MANUAL

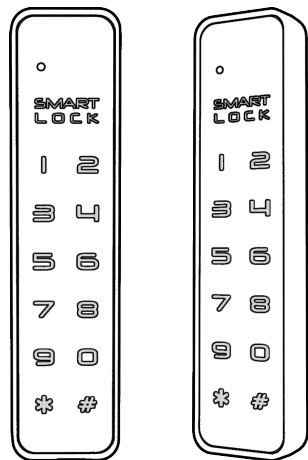

Feature

1. Two passwords, master code and user code
2. Working mode: Private Mode, Public Mode, Limit Public
3. Ukey for management in the business application
4. Visual signal with indicator
5. Energy-saving technology, lifetime of new battery up to 6000 times opening
6. Low battery warning, outer power supply by USB port

1. How to set individual mode

- Insert UKey
- Enter 44#1#, automatic mode enabled
- Enter 44#2#, manual mode enabled

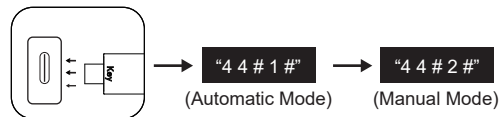

2. How to change user password (Factory Setting: 1-2-3-4)

- Press * for 2 seconds, Red light
- Enter current user password code and #
- Enter 1 and #
- Enter new user password and #
- Enter new user password and # again, "Beep, Beep", new user password enabled



3. How to change master password

- Press * for 2 seconds, Red light
- Enter current master password and #
- Enter 2 and #
- Enter new master password and #
- Enter new master password and # again, "Beep, Beep", new master password enabled



4. How to lock

1. Individual Automatic Mode
 - Push the door closed, door locks automatically
2. Individual Manual Mode
 - Push the door closed
 - Enter #, latch comes out, locked

5. How to unlock

1. User password or master password
 - Enter user password and #, "beep,beep", unlocked
 - Pull door open



How to initialize the lock

- Insert UKey
- Enter 11#, "beep,beep", system initialized
- Note: System initialized, all fingerprints deleted, user password: 1-2-3-4, master password: 5-4-3-2-1-5

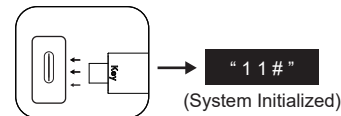

1. How to set public mode

- Insert Key
- Enter 44#3#, public mode

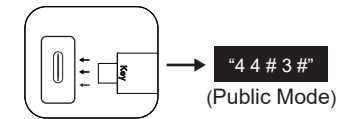

2. How to lock

- Push the door closed
- Enter any password and #, "beep,beep"
- Latch comes out, locked



3. How to unlock

- Enter the password and #, "beep,beep", unlocked
- Pull door open



Note:

- 1) One-time password
- 2) When unlock, the latch retracts, next guest will use his/her password to lock the door

Other Function

E-key

- 1.Insert UKey
- 2.Pull the door open

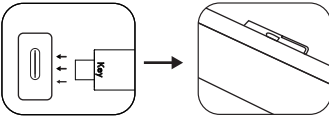

2. Low Battery Warning

- 1.If "Beep Beep ..." 6 sounds after door opened,red light flashes six it indicates low battery then change new battery in time
- 2. Note: Use 3XAAA alkaline battery, not take Carbon battery

3. Outer Power Supply

When low battery, can connect power bank or mobile plug for outer power supply
After unlocked, change the battery immediately

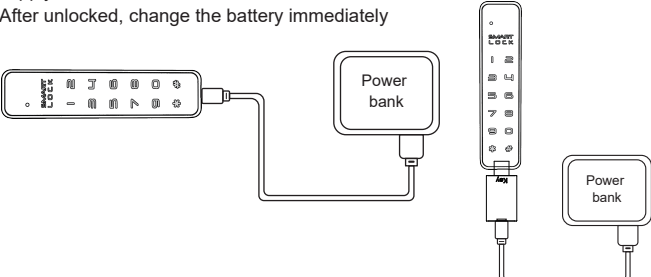

Installation Instructions

- 1. Put the installation drawing on the door, approx. 45mm between the door frame and center hole (Picture 1), then drill the hole

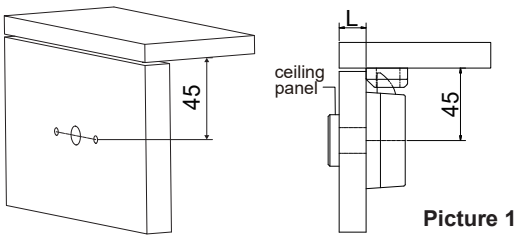

Picture 1

wire connection

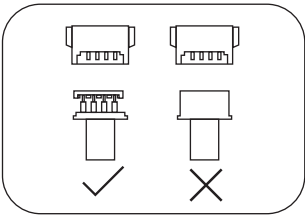

- 2. Install the front panel and back lock
 - 2.1) All-in-One installation
Wire goes through the center hole and connect back lock, (Tide up the wire not crush), fix the panel and back lock by crew M4X18
 - 2.2) Separation installation
Wire goes through the center hole and fix the front panel by screw M4X16 and washer, then connect the back lock, (Tide up the wire not crush), fix back lock by crew ST3.5X18
- 3. Fix the striking plate by screw ST3.5X18(Make sure latch works well)

All-in-one installation—Chart ①

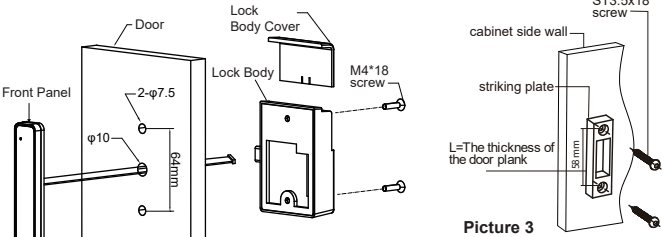

Picture 3

Picture 2

| | | | |
|---|---|--------------------|----------------------------|
|  | ① | Door Thickness(mm) | Cross countersunk Screw |
| | 1 | 14mm~18mm | M4X18 |
| | 2 | 18mm~22mm | M4X20 |

Separate installation②

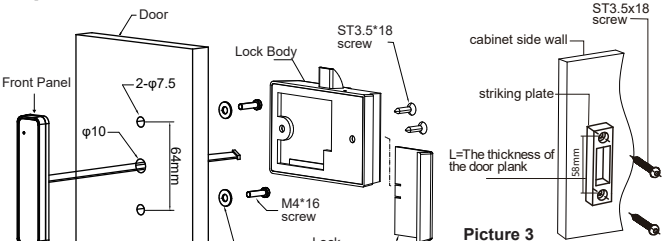

Picture 3

Picture 2

| | | | |
|---|---|--------------------|-------------------------|
|  | ② | Door Thickness(mm) | Phillips pan head Screw |
| | 1 | 14mm~18mm | M4X12 |
| | 2 | 18mm~22mm | M4X16 |

COMPONENT

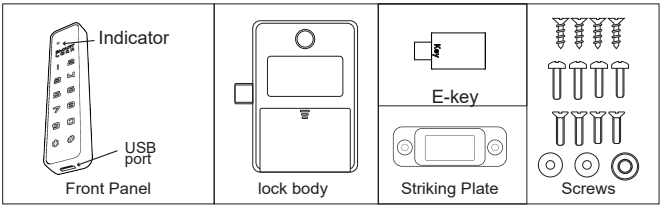

INSTALLATION DRAWING

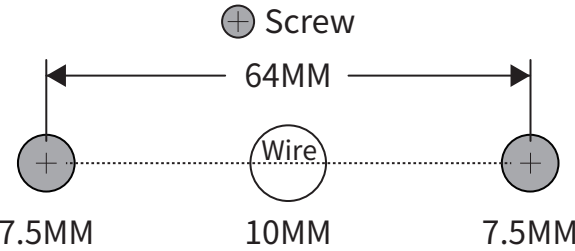

Follow the drawing to drill the hole